

FASTCUT 350 PRO
Tree Shear
7 - 20 t Excavator
14inch / 350mm



**FERNTREE
EQUIPMENT
& DISTRIBUTION**
YOUR QUALITY BRAND CONNECTION



Our Next Generation Shear with
Increased Cylinder Size.
Facts without Comparison.
Shear Force , Weight , Cut
Capacity



FASTCUT 350 PRO



7 – 20 tons



550Kg 1216 lbs



80mm / 3,25"



350 mm / 14"



180 – 350 bar
2610-5000 psi
(min-max)



50-150 l/min
13 - 40 gal/min
(min-max)



Curved Shear arm
Easier Cut
Better delimiting

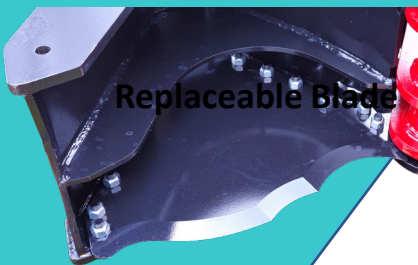

Replaceable Blade

Replaceable Blade
Hardox 500
Heavier Bracing

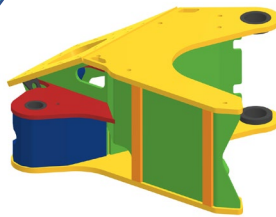

Rigid Frame made
from 5 different
Steel Selections.
XAR 400



Rear Hydraulic Connection L+R.
Flat Base Mount.
Cylinder 20% increased.
Longer leverage (Cyl-Clamp arm)



**FERNTREE
EQUIPMENT
& DISTRIBUTION**

YOUR QUALITY BRAND CONNECTION

**Import & Distribution
North-America**

Info@ferntree.ca
+1 778 222 9111
Guelph Ontario
Canada www.ferntree.ca

